

Notice Pièces de rechange
IDYLLE 39 DC
152119-E-00X

BOS Suspension

*4 Impasse Léonce Couture
ZA du Mont Blanc
31200 Toulouse - FRANCE*



NC_IDYLLE_39_DC

ECLATÉ DU PRODUIT



NOMENCLATURE

152119-E-001_IDYLLE_39_208

REP	NAME	TYPE	REF	IND	QTY
1	CASTING DH 29"	ASSEMBLY	042-SE-001		1
2	TE DH 29"	ASSEMBLY	036-SE-002		1
3	PLONGEUR DH 39MM	PART	152119-D-009	A	2
4	CARTOUCHE AIR DH 39MM	ASSEMBLY	041-SE-001		1
5	CARTOUCHE HYDRO DH 39MM	ASSEMBLY	029-SE-004		1
6	JOINT TORIQUE 38X2 VI	PART	JT380004B5	-	1
7	BUTE CADRE	PART	ADHSP01-08	-	2

SE N°1 : 042-SE-001-CASTING DH 29''



NOMENCLATURE

REP	NAME	TYPE	REF	IND	QTY
1	CASTING DH 39MM X 29"	PART	152119D001-X	B	1
2	BAGUE SUP 35	PART	152119-D-002	-	2
3	BAGUE INF 35	PART	152119-D-003	-	2
4	PLAQUETTE APPUI VIS	PART	150707-D-151		2
5	INSERT VIS AXE	PART	150707-D-124	-	2
6	VIC CHC M5X16 INOX EMPREINTE 5	PART	151916-D-071	.	4
7	RACLEUR 35	PART	152119-D-008	-	2
8	GUIDE DURITE	PART	151815-D-068	B	1
9	JOINT TORIQUE 32X4	PART	JT320010A3	-	2
10	VIS CHC M3X6 INOX	PART	VVCHC0306A0	-	1

AXE DE 15MM

REP	NAME	TYPE	REF	IND	QTY
1	AXE 15MM	PART	151815-D-081	-	1
2	INSERT CLE	PART	151815-D-083	-	1
3	BOUCHON AXE	PART	151815-D-082	A	1
4	ADAPTATEUR AXE 15	PART	151815-D-084	-	1

AXE 20MM

REP	NAME	TYPE	REF	IND	QTY
1	AXE 20MM	PART	151815-D-080	-	1
2	INSERT CLE	PART	151815-D-083	-	1
3	BOUCHON AXE	PART	151815-D-082	A	1

SE N°2 : 036-SE-002-TE-DH-39



NOMENCLATURE

REP	NAME	TYPE	REF	IND	QTY
1	TE INFERIEUR 39MM	PART	152119-D-011	-	1
2	PIVOT DH	PART	150707-D-008	D	1
3	TE SUPERIEUR 39MM	PART	152119-D-010	-	1
4	VIC CHC M5X16 INOX EMPREINTE 5	PART	151916-D-071	.	6
5	VIS CHC M6X16	PART	VVCHC0616A0	-	1

SE N°3 : 041-SE-001 CARTOUCHE AIR DH 39



NOMENCLATURE

REP	NAME	TYPE	REF	IND	QTY
1	APPUI TIGE AIR	PART	151613-D-015	-	1
2	JOINT TORIQUE 13.5X2.5	PART	JT135005A3	-	1
3	JOINT TORIQUE 12X2	PART	JT120004A3	-	1
4	ECROU INFERIEUR	PART	150707-D-115	A	1
5	EMBOUT TIGE INF	PART	151613-D-038	A	1
6	TIGE AIR	PART	151613-D-014	A	1
7	PORTE PISTON AIR	PART	151613-D-021	A	1
8	PISTON AIR	PART	150707-D-167	A	1
9	JOINT TORIQUE 20X2.5	PART	JT200005A3	-	1
10	JOINT TORIQUE 16.5X2	PART	JT165004A3	-	1
11	VIS PISTON AIR	PART	151613-D-023	-	1
12	APPUI RESSORT DETENTE	PART	150707-D-158	B	1
13	JOINT TORIQUE 12X1.5 NBR 70	PART	JT120002A3	.	1
14	JONC TIGE AIR	PART	151108-D-023	-	1
15	RESSORT DETENTE	PART	151108-D-068	-	1
16	CENTRAGE RESSORT DETENTE	PART	151613-D-019	-	1
17	GUIDE TIGE AIR EVO	PART	151613-D-080	-	1
18	JOINT TORIQUE 12.37X2.62 NBR 70	PART	JT123706A3	.	1
19	BAGUE ANTI-EXTRUSION	PART	BAE16212010E	-	1
20	PAP-1208-P10	PART	GT01A12A	-	1
21	JOINT TORIQUE 26X2	PART	JT260004A3	-	2
22	TUBE CARTOUCHE AIR	PART	151613-D-036	-	1
23	BOUCHON CARTOUCHE AIR	PART	152119-D-012	-	1
24	JOINT TORIQUE 33X2	PART	JT330004A3	-	1
25	BOUCHON VALVE	PART	151412-D-053	A	1
26	OBUS SCHADER	PART	319400		1
27	JOINT TORIQUE 4.47X1.78	PART	JT044703A3	-	1
28	VIS CHC M3X6 INOX	PART	VVCHC0306A0	-	1
29	JOINT TORIQUE 3X1.2	PART	JT030019A3	-	1
30	JOINT TORIQUE 25X1.5	PART	JT250002A3	-	2
31	DOUILLE CAARTOUCHE AIR	PART	152119-D-017	-	1
32	JONC CARTOUCHE AIR	PART	151613-D-037	-	1
33	RACLEUR SIMPLE LEVRE CAGE METALLIQUE	PART	JR02B120A	.	1

SE N°4 : 029-SE-004 CARTOUCHE HYDRAULIQUE DH 39



NOMENCLATURE

REP	NAME	TYPE	REF	IND	QTY
1	BOUCHON SUPERIEUR DETENTE	ASSEMBLY	032-SE-004		1
2	TIGE H DH39	PART	152119-D-029	-	1
3	CONTRE ECROU TIGE	PART	150304-D-006	D	1
4	BUTE COMP IDYLLE	ASSEMBLY	021-SE-003		1
5	PORTE PISTON FCV	PART	152119-D-014	-	1
6	MASSE FCV	PART	152119-D-015	-	1
7	GUIDE RESSORT FCV	PART	152119-D-016	-	1
8	RESSORT FCV K40	PART	151613D004/40	.	1
9	RESSORT BUTE DETENTE	PART	150707-D-154	-	1
10	PISTON DET 18 FRITTÉ	PART	151613-D-041	-	1
11	GUIDAGE PISTON DET 18	PART	150707-D-041	-	1
12	SETTING	PART	-	.	1
13	TOP PLATE 13X1.5	PART	230104-D-040	B	1
14	ECROU NYLSTOP M6	PART	VEN06A0	-	1
15	TRANSMISSION DETENTE ALU 442MM	PART	150013D013/442		1
16	POINTEAU DETENTE	PART	151613-D-095	-	1
17	RESSORT	PART	RA1256670A	-	1
18	JOINT TORIQUE 4X1.5	PART	JT040002A3	-	1
19	RESSORT REAL EVO	PART	151613-D-039	-	1
20	CLAPET	PART	CLAPD0815020	-	1
21	GUIDE TIGE CARTOUCHE RARE	ASSEMBLY	016-SE-012		1
22	DOUILLE GUIDE TIGE	PART	151613-D-005	-	1
23	TUBE CARTOUCHE	PART	151613-D-024	-	1
24	BLOC COMPRESSION DH39	ASSEMBLY	002-SE-009		1

SE N°4.1 : 032-SE-004-BOUCHON SUPERIEUR DETENTE



NOMENCLATURE

REP	NAME	TYPE	REF	IND	QTY
1	BOUCHON DETENTE 39MM	PART	152119-D-013	-	1
2	ENTRAINEUR REGLAGE DET	PART	150907-D-005	A	1
3	JOINT TORIQUE 4.47X1.78	PART	JT044703A3	-	1
4	VIS CHC M3X6 INOX	PART	VVCHC0306A0	-	1
5	JOINT TORIQUE 3X1.2	PART	JT030019A3	-	1
6	BILLE D2.5	PART	B25A	-	2
7	JOINT TORIQUE	PART	JT080007A3	.	1
8	JOINT TORIQUE 33X2	PART	JT330004A3	-	1
9	MOLETTE DETENTE	PART	150907-D-007	A	1
10	FHC M4X8 INOX	PART	VVFHC0408A0	-	1

SE N°4.2 : 021-SE-003 BUTEE DE COMPRESSION

NOMENCLATURE

REP	NAME	TYPE	REF	IND	QTY
1	CORPS BUTE COMP	PART	150707-D-026	A	1
2	JONC	PART	091305-D-010	A	1
3	SUPPORT PISTON COMP	PART	150707-D-025	B	1
4	PISTON BUTE COMP	PART	150707-D-024	A	1

SE N°4.3 : 016-SE-012 GUIDETIGE HYDRAULIQUE

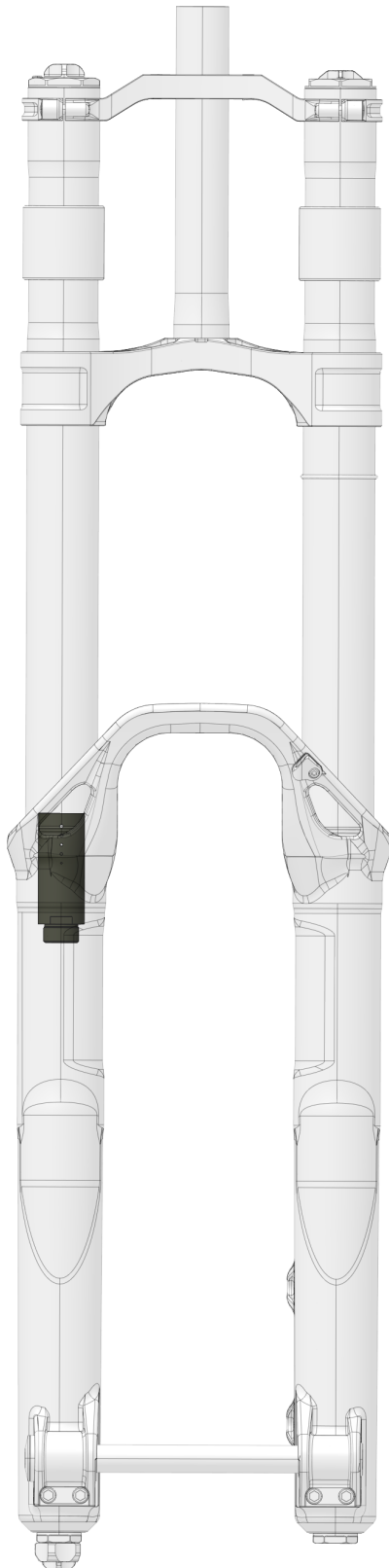

NOMENCLATURE

REP	NAME	TYPE	REF	IND	QTY
1	GUIDE TIGE FUT	PART	150707-D-125	C	1
2	BAGUE PAP-1008-P10 OU P14	PART	GT01A10A	-	1
3	RONDELLE GUIDE TIGE	PART	150707-D-126	.	1
4	CLIPS TYPE 848 D16MM	PART	CTB16B	.	1

SE N°4.4 : 002-SE-009 BLOC DE COMPRESSION IDYLLE

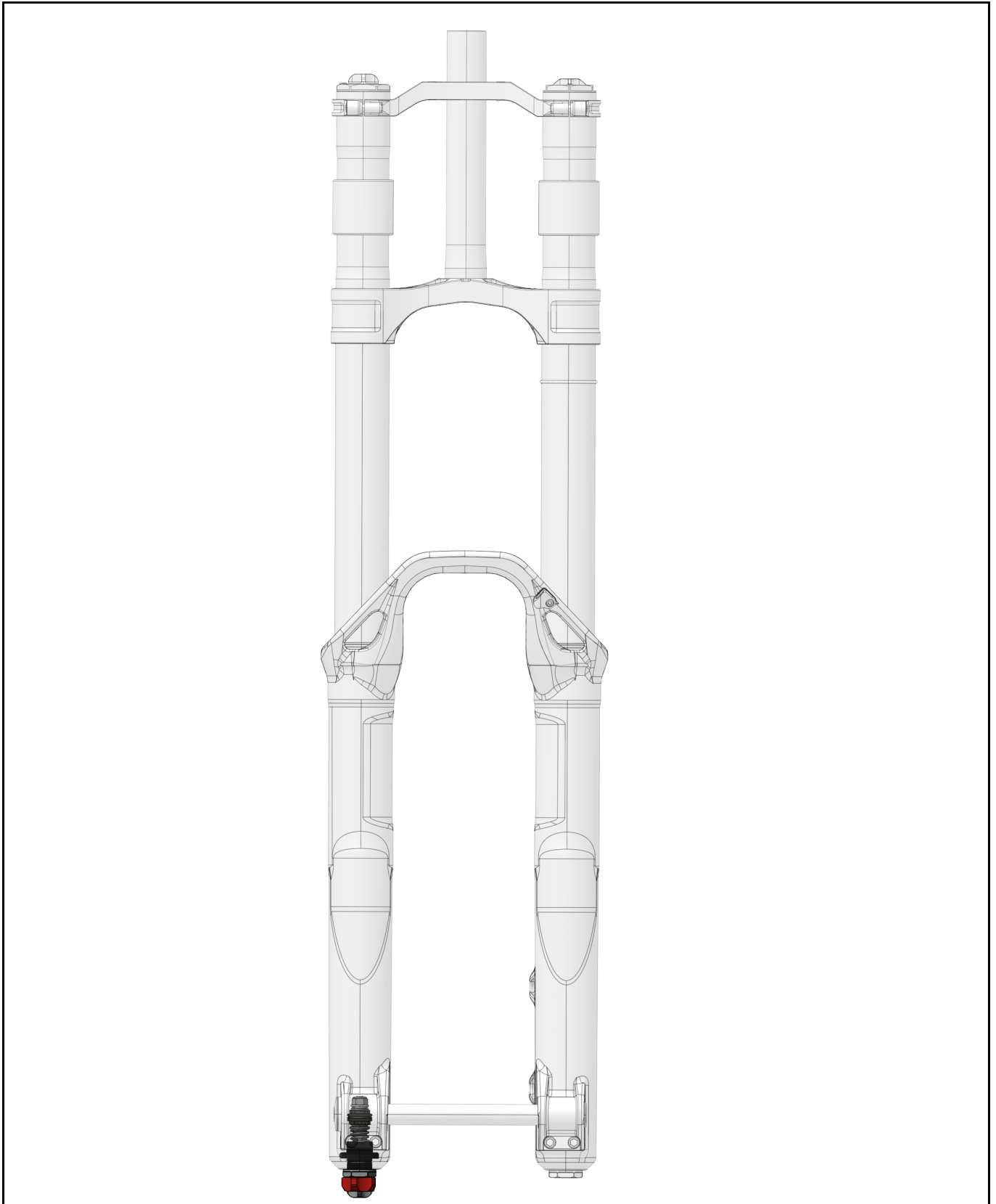

NOMENCLATURE

REP	NAME	TYPE	REF	IND	QTY
1	CORPS COMPRESSION	PART	150707-D-114	D	1
2	VIS STHC M3X4 POINTUE INOX	PART	VVSTHC0304A0PT	.	1
3	RESSORT INDEXATION	PART	RA4025040B	-	2
4	BILLE D2.5	PART	B25A	-	2
5	JOINT TORIQUE 15X1.5	PART	JT150002A3	-	2
6	JOINT TORIQUE	PART	JT100002A3	-	1
7	ECROU INFERIEUR	PART	150707-D-115	A	1
8	MOLETTE COMPRESSION HV	PART	151108-D-028	-	1
9	STHC M3X8 INOX	PART	VVSTHC0308A0	-	1
10	SUPPORT SETTING COMPRESSION	PART	150707-D-118	A	1
11	POINTEAU COMPRESSION BV	PART	151108-D-032	B	1
12	JOINT TORIQUE 4X1.5	PART	JT040002A3	-	1
13	RONDELLE_10X16X0.5	PART	VR101605B	.	1
14	RESSORT REGLAGE HV	PART	150707-D-1125	A	1
15	TOP PLATE	PART	91707-D-011	-	1
16	SETTING	PART	-	.	1
17	PISTON COMPRESSION 18 FRITTÉ	PART	151613-D-042	-	1
18	GUIDE CLAPET REAL	PART	150707-D-023	A	1
19	ECROU NYLSTOP M6	PART	VEN06A0	-	1
20	RESSORT REAL EVO	PART	151613-D-039	-	1
21	CLAPET	PART	CLAPD0815020	-	1
22	APPUI REGLAGE HV 12MM	PART	150707-D-139	-	1
23	MOLETTE COMPRESION BV	PART	151108-D-027		1
24	FHC M4X8 INOX	PART	VVFHC0408A0	-	1

www.bos-suspension.com



4, Impasse Léonce Couture – F31200 TOULOUSE

/ +33(0)5 34 25 33 66

sales@bos-suspension.com